

REVISION HISTORY				
REV	ECN	DESCRIPTION	SIGN & DATE	
			BY	DATE
C		Changes to Dim & Wire Size	RL	6/10/08
D1		Changes to Dim & Wire Size	JL	1/9/07
D2		Revised Description & Added "MAX" to coil Height and OD, (X2) to lead spacing.	KL	6/10/08
			TN	05/06/25
			JL	05/06/25

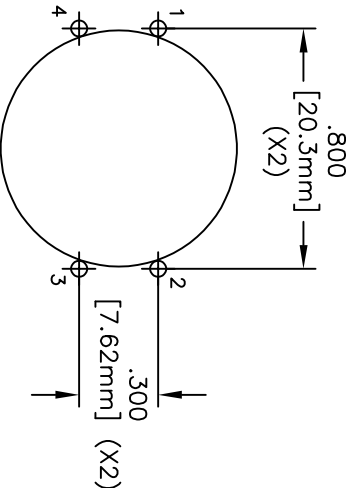
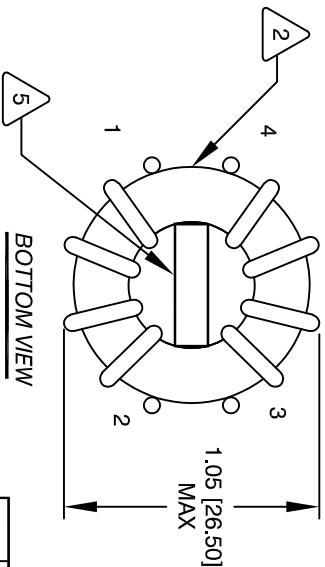
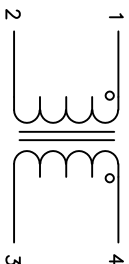
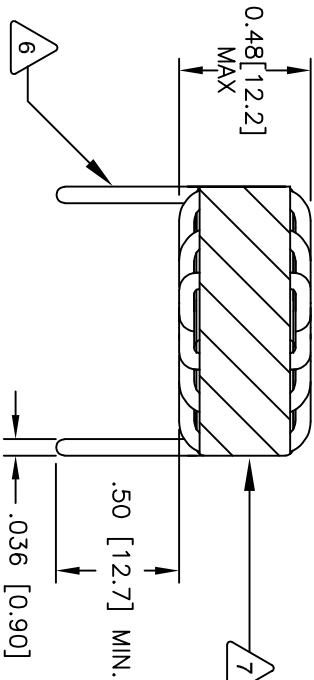

8 Build to RoHS Compliance

7 WHERE SHOWN, USING A PERMANENT MARKING METHOD
MARK PART NUMBER AND REVISION
WRAP INDUCTOR WITH GLASS TAPE

6 TO THE CORE
MUST REST FLAT ON PCB. LEADS MUST BE TANGENT
FLUSH WITH THE CORE EDGE, AS SHOWN (I.E. COIL
REMOVE INSULATION AND TIN LEADS APPROX. 0.5 INCH

5 SPACER : UL 94-V0, NYLON 6/6
WIND BOTH COILS EVENLY SPACED
4 CONSTRUCTION:

INTER-WINDING CAPACITANCE = 15.30 pF
LEAKAGE INDUCTANCE = 10.5 uH
CURRENT RATING = 4.5 AMPS
DCR ON EACH WINDING = 20.0 MILLI-OHMS MAX
L= 1800 uH ± 30%, 10 KHz, 250 mV
3 SPECIFICATIONS:

WIRE: UL RECOGNIZED 155 °C OR 200 °C (PREFERRED) RATED MAGNET WIRE
CWS BYTEMARK OR OTHER APPROVED PART
CORE: COATED FERRITE TOROID, HIGH PERM MNZN

2 RATING CLASS B (130 °C MIN.) REQUIRED
1 MATERIAL: UL RECOGNIZED 94V-0 FOR FLAMMABILITY

NOTES: UNLESS OTHERWISE SPECIFIED. COMMON MODE CHOKE
READ FROM BOTTOM UP.

CODE	IDENT	MFG. P/N	DESCRIPTION	ITEM NO.
PARTS LIST				
AUTOCAD		X	CWS Coil Winding Specialist.	
SOLIDWORKS		DATE	www.coilws.com	
SIGN		DATE	1510 E. Edinger Ave.	
DRAWN		4/13/05	Unit B, Santa Ana, CA. 92705	
RPR		4/13/05	TITLE:	
DEND		4/13/05	Common Mode Line Chokes	
JLAU		4/13/05	SIZE (IMG. NO.)	
ENGR.		4/13/05	B	
KSUM		4/13/05	CM-182U-4.5A	
APPR.		4/13/05	REV	
JLAU		4/13/05	D2	
DO NOT SCALE DRAWING		SCALE	2=1	
		SHEET	1 OF 1	